

使用說明書 INSTRUCTIONS FOR

W-71 SPRAY GUN

型號	噴嘴口徑 Fluid Nozzle Orifice Size mm (in)	使用空氣壓力 Required Air Pressure kgf/cm (psi)	空氣使用量 Air Consumption (at Required Pressure) l/min (c.f.m)	噴塗出漆量 Paint Output cc/min	最大寬幅 Max. Pattern Width cc/min	供給方式 Type of Feed
W-71-1S W-71-2S W-71-3S W-71-4S	1.0 (0.04) 1.3 (0.05) 1.5 (0.06) 1.8 (0.07)	3.0 (45)	75 (2.7) 85 (3.9) 165 (5.8) 230 (8.1)	95 135 180 195	100 (3.9) 135 (5.3) 170 (6.7) 200 (7.9)	Suction 吸上式
W-71-1G W-71-2G W-71-3G W-71-4G	1.0 (0.04) 1.3 (0.05) 1.5 (0.06) 1.8 (0.07)	3.0 (45)	75 (2.7) 85 (3.9) 165 (5.8) 230 (8.1)	110 155 210 220	120 (4.7) 155 (6.1) 185 (7.3) 230 (9.1)	Gravity 重力式

※Recommended for High Quality Finishing and Metallic Paint

用途:

本噴槍適用於各類車輛、傢俱、儀表、機械設備的噴塗以及賓館、住宅、商厦等裝潢塗裝作業。

使用方法:

- 使用前先將塗料罐和氣管與槍體連接緊密。
- 將槍體上的氣管接上2.5-4.5kgf/cm²壓力的壓縮空氣源，氣流進入噴槍前，須經油水分離器過濾。
- 裝料：用4#杯將塗料用相應溶劑稀釋調勻后，再經7.8mm孔徑的濾網過濾后再將塗料倒入塗料罐內。
- 使用時，稍微扳動扳機，使氣閥打開，但針塞未打開，壓縮空氣從氣流噴嘴噴出，這時可以吹去塗裝表面的灰塵，接着繼續往後扳動扳機噴嘴即噴出漆霧。
- 噴霧以150-200mm為最佳距離。

調節裝置:

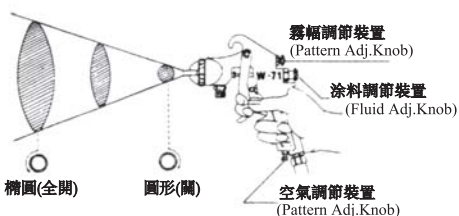

注意事項:

- 不可用銳利的金屬絲通噴嘴和氣流噴嘴各小孔，否則任何損壞會引起噴霧的不正常。
- 噴漆槍清洗時不得長時間浸泡在稀溶劑中。
- 用稀溶劑清除槍體內管道。
- 切勿在塗料粘結于潤後拆修。
- 本噴漆槍主要零件為鋁合金和黃銅材料制成，不宜接觸酸、鹼性較強的介質，以防腐蝕損壞。

HOW TO USE

- Fluid Cup, Container and Air Hose should be connected tightly with Spray Gun.
- Required Air Pressure should be adjusted by viscosity and feature of paint. Proper Air Pressure of 2.5 ~ 4.5kgf/cm² is recommended
- Proper Material Viscosity is 17-23sec at 4# cup Viscosimeter.
- A spraying distance of 150mm-200mm(6in-8in.) is recommended.

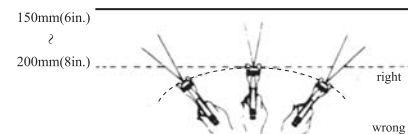

HOW TO ADJUST

The desired pattern, volume of fluid output and fine atomization can easily be obtained by regulating the Pattern Adjusting Knob, Air Adjusting Knob and Fluid Adjusting Knob.

- Adjusting pattern: Turning Pattern Adjusting Knob to the left will make spray pattern wider.
- Adjusting volume of fluid output: Turning the Fluid Adjusting Knob clockwise will reduce the volume of fluid output and counter-clockwise will increase fluid output.
- Adjusting air volume: Turning the Air Adjusting Valve clockwise will reduce the air volume and air volume.

CAUTION AND AFTER USE CARE

- Be extremely careful not to damage the Air Cap, Fluid Nozzle or Fluid Needle.
- Use the brush with thinner to clean Air Cap, Fluid Nozzle and other parts. Never immerse spray gun completely in thinner or solvent
- Spray thinner to clean out the paint passage-way.
- When reassembly, always clean parts to prevent the sticking of dust.
- Packing Seat should not be so tight otherwise it interferes with the free movement of the Needle just secure enough to prevent leakage.

※故障原因及排除方法 CAUSES OF DEFECTIVE PATTERNS AND COUNTERMEASURES

故障現象	故障原因	排除方法
PATTERN	CAUSE	COUNTERMEASURE
1. Fluttering or Spitting spray 跳漆	1. 噴料嘴與槍體密封不良。 2. 料罐接頭帽漏氣。 3. 針塞密封螺絲過松漏氣。 a. Dry or worn Needle packing set or loose packing Seat permits air to fluid passage. b. Dirt between Fluid Nozzle taper seat and Body. c. Loose or cracked Fluid Joint connecting container to gun.	1. 旋緊噴料嘴 2. 旋緊料罐，接頭螺帽。 3. 調節針塞密封螺絲松緊要適宜。 a. Lubricate or replace Needle Packing set b. Tighten or replace Fluid Nozzle. c. Tighten or repair them.
 2. pattern is arc 弧形霧狀	1. 氣流噴嘴尖頭兩側小孔有穢物堵塞，兩尖頭孔出氣量，不均產生氣流偏斜。 a. Material build up on air cap, partially clogged horn holes. b. Full pressure of air from clean horn hole forces fan pattern in direction of clogged side.	1. 清除氣流噴嘴尖頭兩側小孔穢物。 a. Remove obstructions from horn holes or submerge it in thinner or suitable solvent and wipe clean. b. In this case, be careful not to damage air holes with metal objects.
 3. pattern is not evenly spread 漆霧兩端不勻	1. 氣流噴嘴小與噴料嘴 2. 安裝不良，有穢物卡住。 a. Material build up on the periphery of the Fluid Nozzle orifice or center hole or partially clogged nozzle orifice. b. Loose Fluid Nozzle.	1. 清除氣流噴嘴與噴料嘴上的穢物，使氣流噴嘴接觸面良好，并旋緊氣流噴嘴。 2. 擰緊噴料嘴。 a. Remove obstructions. Never use a wire or hard instruments. b. Tighten Fluid Nozzle.
 4. The center of pattern too narrow 漆霧兩端多中間少	1. 幅度調節螺絲開過大，產生氣量過大 2. 漆液過稀 a. Too high and atomization air pressure. b. Material too thin.	1. 調節幅度螺絲，減少開度使氣量減小。 2. 調稀漆液粘度。 a. Reduce air pressure. b. Regulate material viscosity.
 5. pattern width of fan-shaed is not enough 擴散霧面不寬	1. 空氣工作壓力過低。 2. 塗料粘度過高。 a. Low atomization air pressure. b. Too thick material.	1. 提高空氣工作壓力。 2. 用塗料稀釋劑調稀塗料，用粘漆-4 杯測試達到流速17-24秒最好。 a. Raise air pressure. b. Regulate material viscosity

部件名稱 PARTS LIST

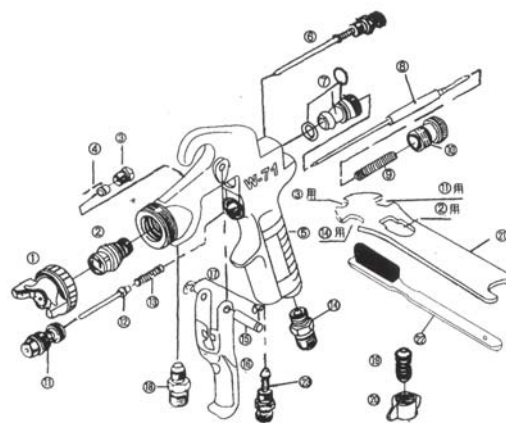

NO	電腦編號	部件名稱	Description
1	W7101	噴頭	Air Cap Sel
2	W7102/023	噴嘴	Fluid Nozzle
3	W71041	密封座	Needle packing seat
4	W71042	密封墊片	Packing Fluid Needle
5	W7105	槍體	Gun Body
6	W7106	擴散調節裝置	Spread Adj valve set
7	W7108	塗料調節導套	Fluid Adj Guide
8	W7109	塗料調節針	Fluid Needle set
9	W7110	塗料調節彈簧	Fluid Needle spring
10	W7112	塗料調節旋鈕	Fluid Adj knob
11	W7113	氣閥門裝置	Air Valve seat set
12	W7114	氣閥門針	Air Valve seat set
13	W7115	氣閥門彈簧	air valve spring
14	W7117	進氣接頭	air Hose Joint
15	W7118	扳機銷	Trigger stud
16	W7119	扳機	Trigger stud
17	W7120	扳機扣環	Stop Ring
18	W7121	塗料接頭	Fluid Joint
19	W7124	管接頭	Hose
20	W7125	蝶形螺母	Joint
21	W7126	扳手	Spanner
22	W7127	清潔刷	Brush
23	W7128	進氣裝置	Air Adj Valve set

檢查合格

INSPECTED